

Spec. No.: HL5050-6P026W-BNNN:660A4730D810D850B940B

Issued Date: 2017-5-12

# SPECIFICATION

Model Name: Multi Emitters 660/730/810/850/940

Model NO. : HL5050-6P026W-B

Customer No.:

Prepared by: Dong Yong Wei

Approved by: Xie Zhong Wu

Customer approved by: \_\_\_\_\_



Add: 4 floor, 4 building, WuWu Technology Park, Longhua New District,  
ShenZhen, Guangdong, China

Tel: 86-0755-28147404

Fax: 86-0755-28149249

E-mail: [xwjma@163.com](mailto:xwjma@163.com)

<http://www.szwhaley.com/>

# Multi Emitters

HL5050-6P026W-B

## ■Features

- molded packages
- 6pin designs
- Multi wavelengths LEDs
- Matching detector response

## ■Applications

- SPO2
- Blood analysis
- Medical instrumentation
- Radiometric instruments

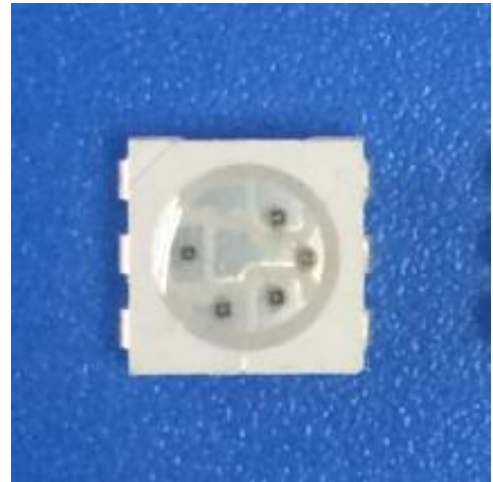

Name	Model	RED	IR	IR	IR	IR	Package
Multi Emitters	HL5050-6P026W-B	660	730	810	850	940	6Pin, COB

## ■Absolute Maximum Ratings

(Ta= 25℃)

Parameter	Symbol	Max.	Unit	Note
Power Dissipation	P <sub>d</sub>	60	mW	---
Forward Current	I <sub>F</sub>	20	mA	---
Peak Forward Current	I <sub>FP</sub>	100	mA	1/10 Duty cycle, 0.1ms pulse width
Reverse Voltage	V <sub>R</sub>	5	V	---
Operating Temperature	T <sub>opr</sub>	-25~+85	℃	---
Storage Temperature	T <sub>Stg</sub>	-40~+100	℃	---
Soldering Temperature	T <sub>S01</sub>	260	℃	260℃ for 3 Seconds

## ■Electrical/Optical Characteristics

(Ta= 25℃)

Parameter	Symbol	Min.			Typ.			Max.			Units	Test Conditions
		660	810	940	660	810	940	660	810	940		
Forward Voltage	V <sub>F</sub>	1.8	--	1.55	--	1.55	--	2.4	1.8	1.75	V	I <sub>F</sub> =20mA
Reverse Current	I <sub>R</sub>	--	--	--	--	--	--	10	--	10	uA	V <sub>R</sub> =5V
Radiant Power	P <sub>o</sub>	6	1.2	1.7	--	--	2.2	11	2.3	3.0	mW	I <sub>F</sub> =20mA
Peak Wavelength	λ <sub>p</sub>	--		--	663	810	940	--		--	nm	I <sub>F</sub> =20mA
Spectral Line Half-width	Δλ	--		--	50	40	15	--		--	nm	I <sub>F</sub> =20mA

## Multi Emitters

### HL5050-6P026W-B

Parameter	Symbol	Min.		Typ.		Max.		Units	Test Conditions
		730	850	730	850	730	850		
Forward Voltage	VF	--	--	1.78	1.45	2.00	1.6	V	IF=20mA
Reverse Current	IR	--	--	--	--	10	10	uA	VR=5V
Radiant Power	Po	1.0	3.0	2.0	--	--	--	mW	IF=20mA
Peak Wavelength	$\lambda_p$	--	--	735	850	--	--	nm	IF=20mA
Spectral Line Half-width	$\Delta\lambda$	--	--	30	50	--	--	nm	IF=20mA

### ■Dimension:

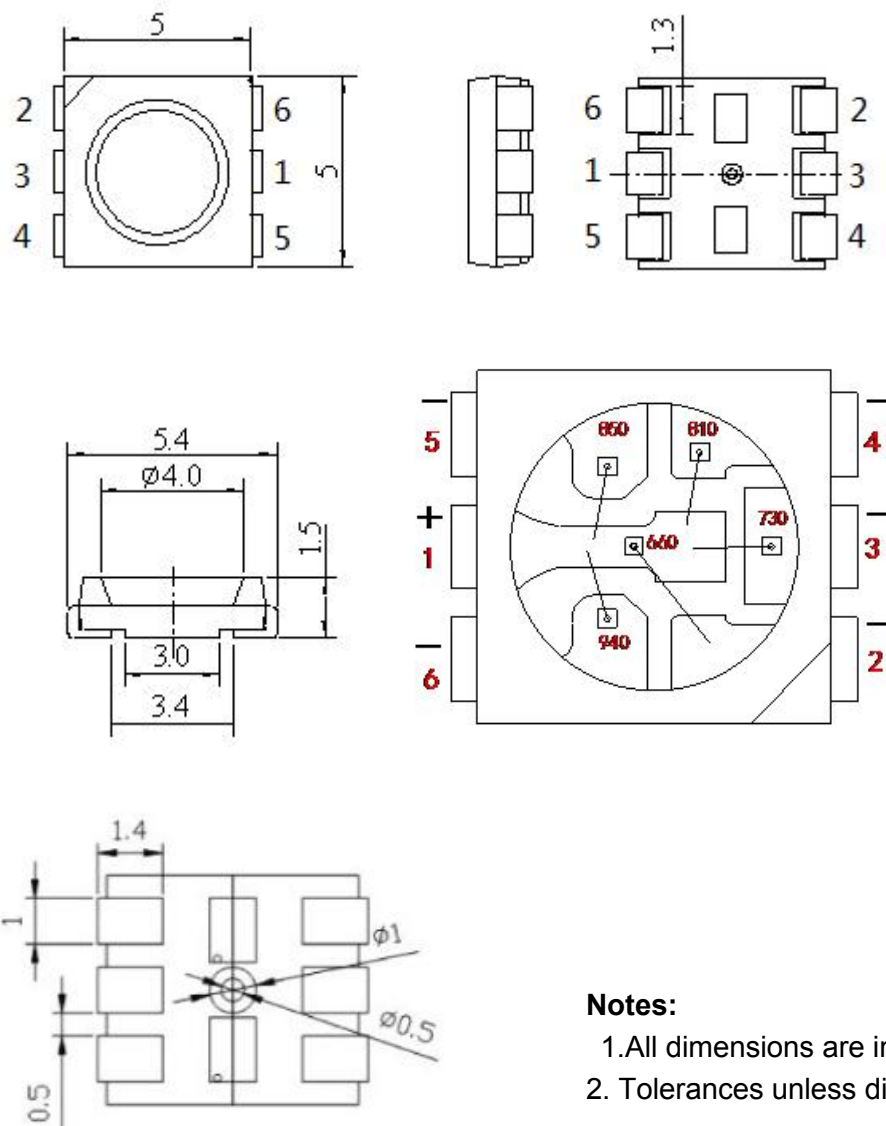

### Notes:

1. All dimensions are in millimeters
2. Tolerances unless dimensions  $\pm 0.1$ mm

### ■ Storage and Soldering Condition

1. Do not open moisture proofs bag before the products are ready to use
2. Before opening the package, the LEDs should be kept at 30°C or less and 90% RH or less.
3. The LEDs should be used within a year.
4. After opening the package, the LEDs should be kept at 30°C or less and 70% RH or less.
5. The LEDs should be used within 168 hours (7 days) after opening the package.
6. If the moisture adsorbent material (silica gel) has fabled away or the LEDs have exceeded the storage time, baking treatment should be performed using the following conditions. Baking treatment: 60±5°C for 24 hours.
7. When soldering, do not put stress on the LEDs during heating.
8. After soldering, do not warp the circuit board
9. Each terminal is to go to the tip of soldering iron temperature less than 260°C for 5 seconds within once in less than the soldering iron capacity 25W. Leave tow seconds and more intervals, and do soldering of each terminal. Be careful because the damage of the product is often started at the time of the hand solder.